

Logistec



Logistec 1500/3600 Electric Straddle Stacker

The Logistec Straddle Stacker is made to high standards with a focus on reliability. Parts and service backup is provided by Sitecraft. It features innovations such as an efficient regenerative braking system and electric power steering.

Logistec 1500/3600 Electric Straddle Stacker

Performance



- The innovative AC system offers strong power, accurate control and excellent performance.
- High strength vertical gearbox provides reliable uptime.
- Low-noise and durable hydraulic unit, high quality cylinder as well as hose ensure the high reliability of hydraulic system.
- AMP connector and durable electric wires greatly reduce malfunctions of components.
- H shape channel mast improves the strength of the whole truck.

Safety



- Safe hydraulic system design prevents mast from falling down abruptly when hydraulic pipeline cuts off.
- Emergency reverse belly button protects the operator from getting hurt.
- Emergency disconnecter will cut off power source to avoid accident when truck goes out of control.
- Multiple lifting limit protection ensures safety.
- Automatic switch to lower speed when the fork reaches its setting height.
- Anti-rolling back brake keeps the truck from skidding down when truck is out of control or travelling on ramp.
- Long side tiller reduces operator's hazards.

Operation



- Ergonomic tiller bounded with key switch, BDI and trouble shooting indicator enhances easy and accurate operation.
- Long tiller offers easier operation.
- Compact chassis design offers smallest turning radius needed Side operating ensures excellent visibility.
- On-board Charger.

Maintenance



- Maintenance-free Battery.
- Battery display indicator with hour meter, reminds operator of charging on time (optional).
- Easy Maintenance - detachable rear panel.
- Vertical motor makes the inspection & service much more convenient.
- Easy Access of Hand Set.
- Low-voltage Cut-off Protection.

Logistec 1500/3600 Electric Straddle Stacker

Specifications

Distinguishing mark	1.1	Manufacturer			Logistec
	1.2	Model designation			Logistec 1500/3600 Straddle Stacker
	1.3	Drive			Electric
Service	1.4	Operator type			Pedestrian
	1.5	Load capacity	q	kg	1500
	1.6	Load center distance	c	mm	600
Tyres/chassis	1.8	Load distance, Centre of drive axel to fork	x	mm	730
	1.9	Wheelbase	y	mm	1165
	2.1	Service weight		kg	915
	2.2	Axle loading, laden front/rear		kg	825/1590
	2.3	Axle loading, unladen front/rear		kg	560/355
	3.1	Tyre type			Polyurethane
	3.2	Tyre size, front		mm	Φ230 x 75
	3.3	Tyre size, rear		mm	Φ102 x 73
	3.4	Additional wheels (castor wheels)		mm	Φ100 x 50
	3.5	Wheels, number front/rear (x=drive wheels)		mm	1x +1/4
Dimensions	3.6	Tread width, front	b10	mm	538
	3.7	Tread width, rear	b11	mm	1170/1270/1370
	4.0	Max. Lift Height	h	°	-
	4.2	Retracted mast height	h1	mm	2128
	4.3	Free lift	h2	mm	-
	4.4	Lift height	h3	mm	3220
	4.5	Height, mast extended	h4	mm	4210
	4.6	Initial lift	h5	mm	-
	4.9	Height of tiller handle in drive position min./max.	h14	mm	1150/1480
	4.10	Height of wheel arms	h8	mm	101
	4.15	Lowered height	h13	mm	60
	4.16	Overall length	l1	mm	1650
	4.20	Length to face of forks	l2	mm	580
	4.21	Overall width	b1/b2	mm	1270/1370/1470
	4.22	Fork dimensions	s/e/l		40/100/1070
	4.24	Fork carriage width	b3	mm	800
	4.25	Distance between fork-arms	b5	mm	200-780
4.26	Distance between wheel arms/loading surfaces	b4	mm	1070/1170/1270	
Perfor- mance data	4.31	Ground clearance, laden, below mast	m1	mm	40
	4.32	Ground clearance, center of wheelbase	m2	mm	30
	4.34.1	Aisle width for pallets 1000x1200 crossways	Ast	mm	2250
	4.34.2	Aisle width for pallets 800x1200 crossways	Ast	mm	2200
	4.35	Turning radius	Wa	mm	1400
	5.1	Travel speed, laden/unladen		km/h	5/5
	5.2	Lifting speed, laden/unladen		m/s	0.14/0.2
	5.3	Lowering speed, laden/unladen		m/s	0.13/0.11
	5.8	Max. gradeability, laden/unladen		%	8/16
	5.10	Service brake			Electromagnetic
Electric- engine	6.1	Drive motor rating S2 60 min		kw	1.27
	6.2	Lift motor rating at S3 15%		kw	3
	6.4	Battery voltage/nominal capacity		V/ah	24/125
Addi- tion	6.5	Battery weight		kg	60
	8.1	Type of drive unit			AC
	10.5	Steering design			Mechanical
	10.7	Sound pressure level at the driver's ear		dB(A)	74

If there are improvements of technical parameters or configurations, no further notice will be given. The diagram shown may contain non-standard configurations.

Mast Options

Mast Type	Lift height h3+h13 (mm)	Height, mast lowered h1(mm)	Free lift h2 (mm)	Height, mast extended h4 (mm)
2 Standard Mast	2490	1728	-	3410
	2690	1828	-	3610
	2990	1978	-	3910
	3290	2128	-	4210
	3590	2278	-	4510

Options

No.	Option items	Logistec CQE15R
1.1	Fork dimension	● 900*600 2A 100*40*1070 ○ 900*600 2A 100*40*1150 ○ 900*600 2A 100*40*1220 ○ 900*600 2A 100*40*1370
1.2	Leg width	● 1070 ○ 1170/1270
1.4	Fork carriage width	● 800mm
1.5	Fork carriage height	● 916mm
2.1	Load wheel type	● Double
2.2	Load wheel material	● PU
2.3	Drive wheel material	● PU ○ Trace PU
2.7	Battery capacity	● 125Ah ○ 100Ah (Li-ion)
2.8	Charger	● 24V-15A Internal
2.9	Battery indicator	● With time
2.16	Handle head type	● Hands big handle head
3.3	Castor wheels	● Yes and not customized
3.16	Vertical handler working	● No ○ Yes and not customized
	Note	● Standard ○ Optional - n/a

Rated Capacities Graph

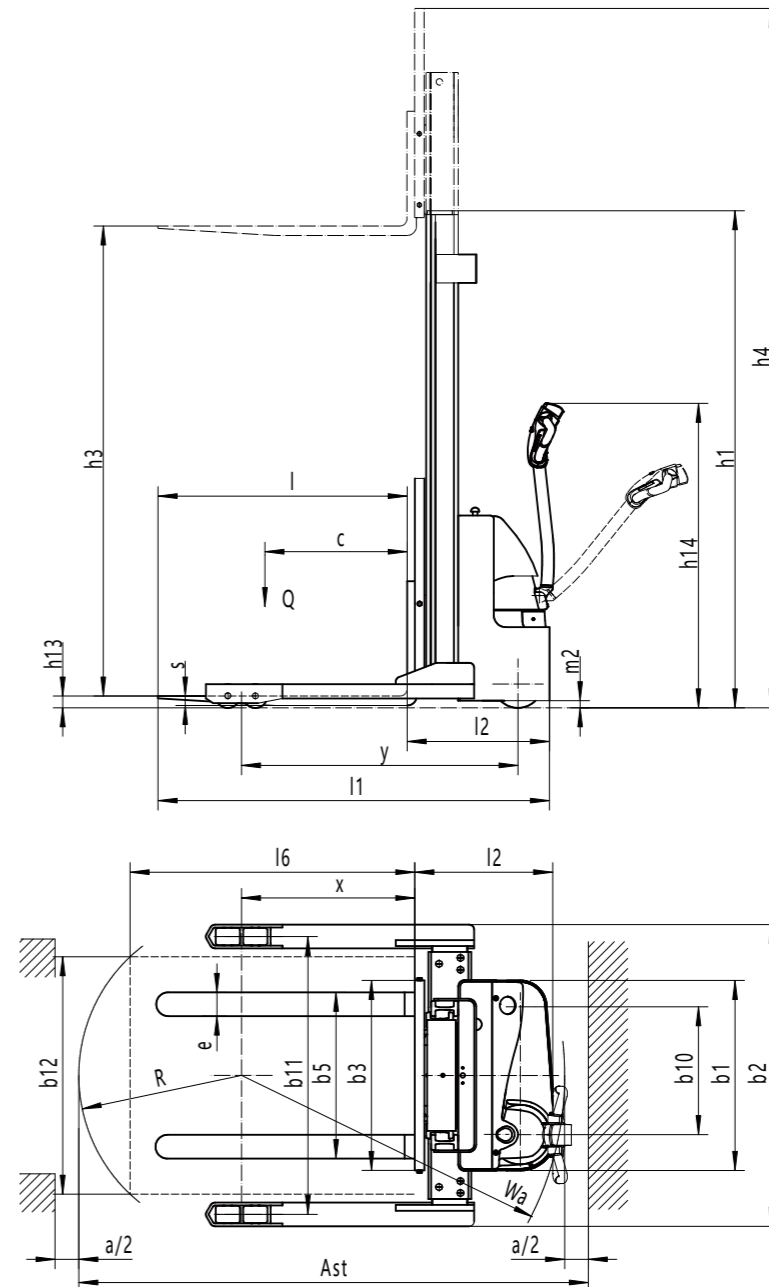
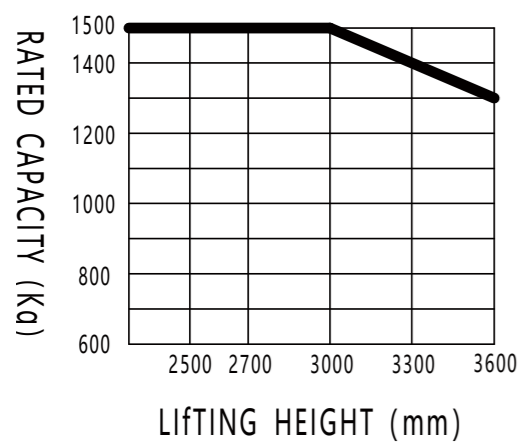



www.sitecraft.net.au | 1300 363 152 | sales@sitecraft.com.au